

JBC

www.jbctools.com



Four-Tool Power Supply Unit

Ref. PSE-A

Packing List

The following items should be included:

- Four-Tool Power Supply Unit** 1 unit
Ref. PSE-1A (120V)
PSE-2A (230V)
PSE-9A (100V)



- Power Cord** 1 unit
Ref. 0010569 (230V)
0013671 (100/120V)



- Manual** 1 unit
Ref. 0013606



Features & Connections

PSE Unit

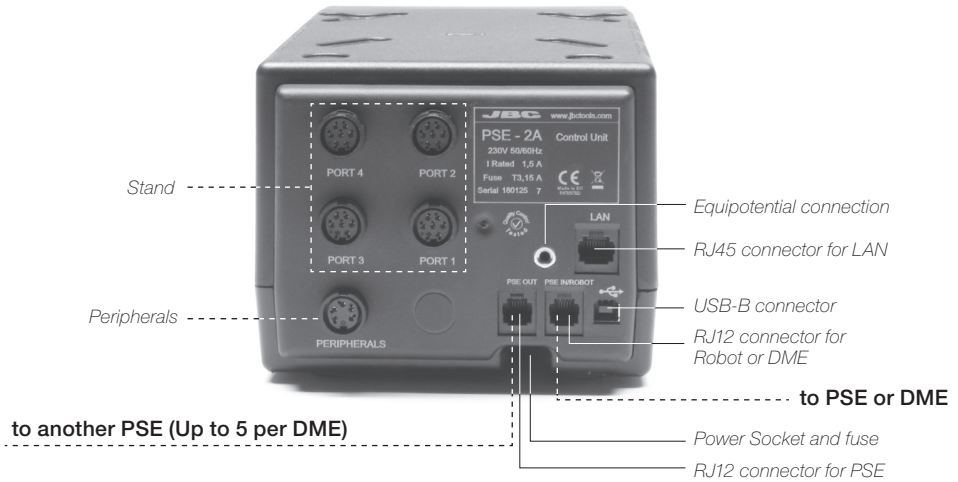

Compatibility

Select the equipment that best suit your soldering or desoldering needs.

Basic working system				Peripherals**			
Control Unit	Stand	Tool	Cartridge Range	MSE-A / MVE-A	MNE-A	FSE-A	P-005
PSE	AD-SD	T210-A	C210			●	●
		T245-A	C245			●	●
		T470-A	C245			●	●
	DN-SE	T210-NA*	C210				
		T245-NA*			●		
		T470-NA*	C245			●	
	AP-SD	AP250-A	C250			●	●
	PA-SD	PA120-A	C120			●	●
	HT-SD	HT420-A	C420			●	●
	DS-SD	DS360-A	C360	●			●
DR-SD	DR560-A	C560	●			●	

* The MNE Nitrogen Flow Regulator is required.

If you need to connect the **MS, MV, MN or **FS** modules, an adapter is required (Ref. IM2496).

Increase x6 your DME's possibilities

Centralize **control of 5 PSE Power Supply Units** in a single DME and work with as many as 24 tools simultaneously.

1. Connect the DME to the PSE units via the PSE connector (RJ12).
2. Connect the others PSE units as follows:

Four-Tool Control Unit

Ref. DME-A

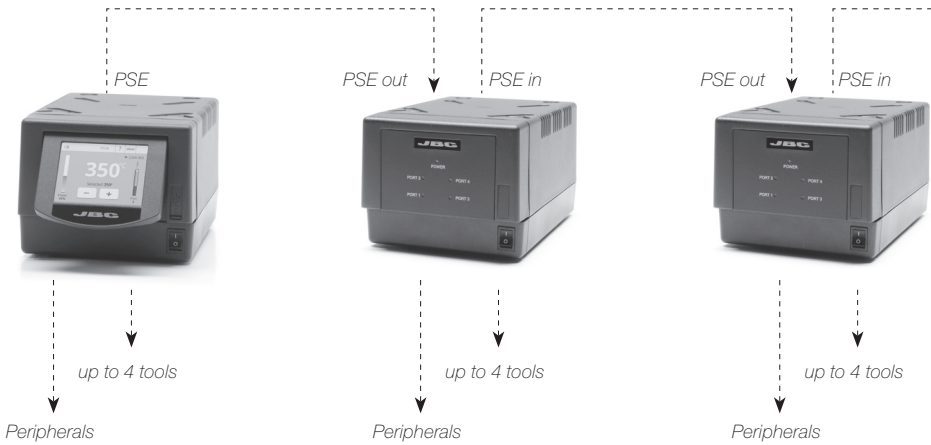

Electric Desoldering Module

Ref. MSE-A



Pneumatic Desoldering Module

Ref. MVE-A

Pedal
Ref. P-005



Peripherals



By pressing **Peripherals** in the main MENU (DME), you can join tool ports with peripherals which means each tool can work with 1 module and 1 pedal at the same time.

Four-Tool Power Supply Unit Ref. PSE-A



Nitrogen Flow Regulator Ref. MNE-A



Fume Extractor Switch Ref. FSE-A

Pedal Ref. P-005



Soldering Net

Remotely manage and monitor as many stations as your PC can handle.

1. Download the **JBC Manager software** and the user manual from www.jbctools.com/manager.html
2. Connect the stations via USB-B or LAN (Ethernet) and the PC will automatically detect them.
3. The notification  will be displayed on the DME Control Unit or PC.

Functions:

- Set all the station parameters from your PC.
- Organize groups of stations and set all their parameters at the same time.
- Store specific configurations for later uses.
- Analyze the soldering graphics of the stations on your PC and export them.

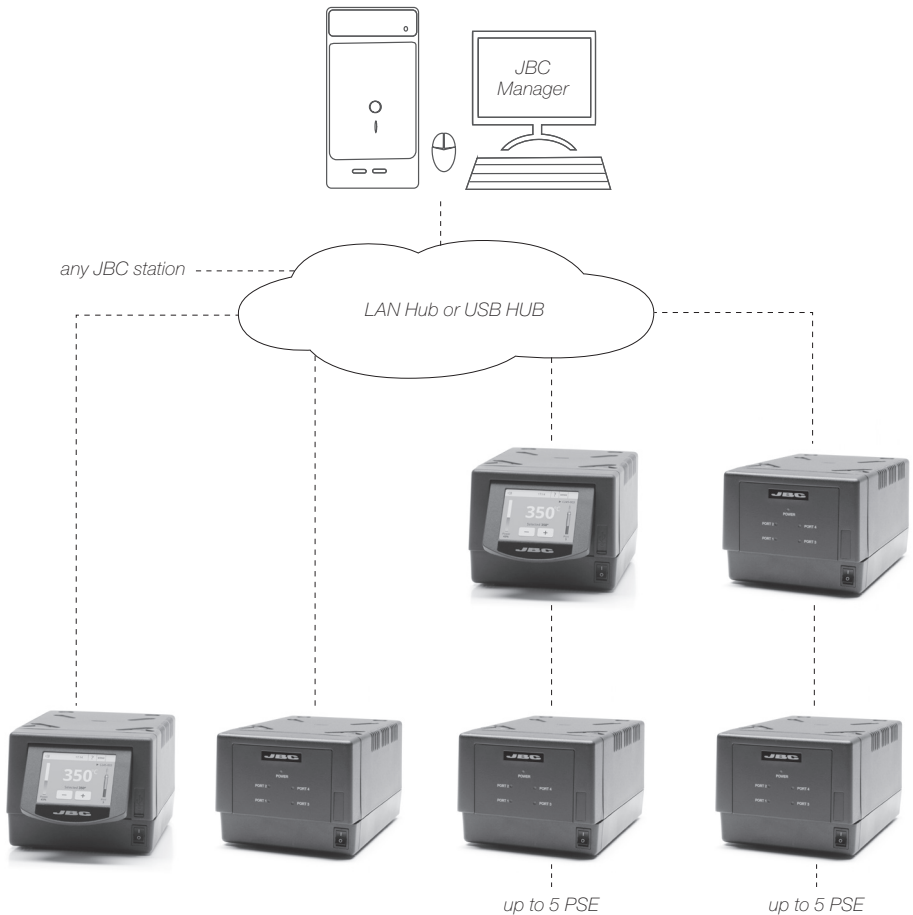

Working with Robots

Manage and monitor the station using a Robotic system.

1. Connect the tool to the station port by means of the CHB-A Converter.
2. Connect your Robot system to the Robot connector (RJ12) of the station.
DB9-RJ12 Adapter available only if necessary (Ref: 0013772).
3. Enable the Robot option in the station settings and the notification will be displayed: 
4. Set your Robot's commands according to the Robot Communication Protocol, available on the website www.jbctools.com/jbcsoftware-menu-115.html

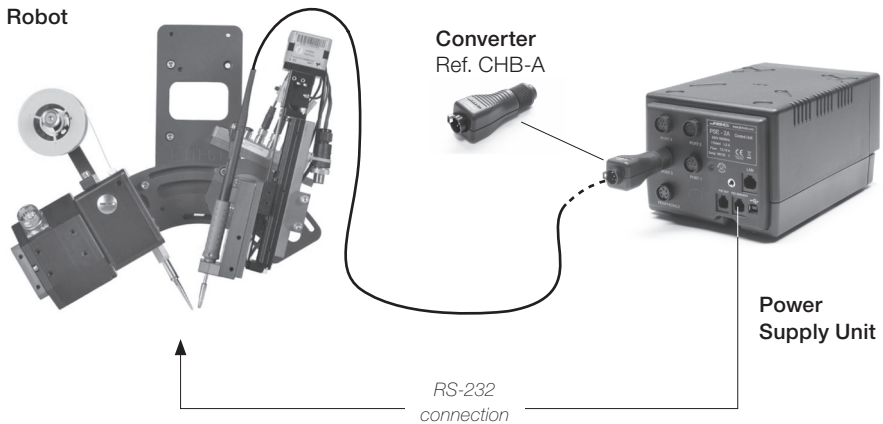

Update the station software

1. Download the JBC Update File from www.jbctools.com/manager.html

2. Connect the LAN (Ethernet) or USB cable to the station. The icon  is displayed in the station or PC while updating.

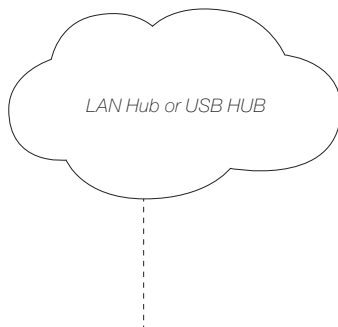

Maintenance

Before carrying out maintenance or storage, always allow the equipment to cool.

- Use a damp cloth to clean the casing and the tool. Alcohol can only be used to clean the metal parts.
- Periodically check that the metal parts of the tool and stand are clean so that the station can detect the tool status.
- Maintain tip surface clean and tinned prior to storage in order to avoid tip oxidation. Rusty and dirty surfaces reduce heat transfer to the solder joint.
- Periodically check all cables and tubes.
- Replace a blown fuse as follows:

1. Pull off the fuse holder and remove the fuse. If necessary use a tool to lever it off.

2. Press the new fuse into the fuse holder and replace it in the station.

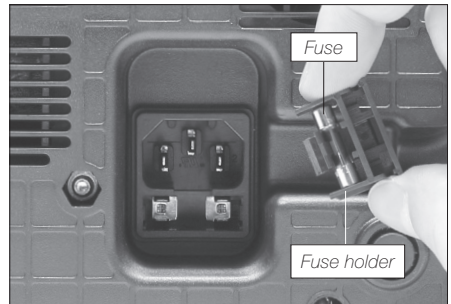
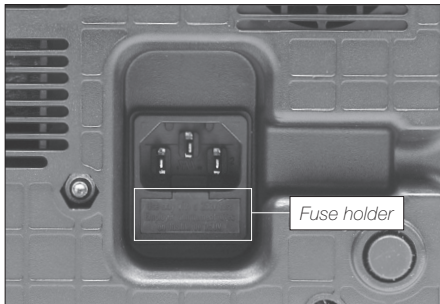

- Replace any defective or damaged pieces. Use original JBC spare parts only.
- Repairs should only be performed by a JBC authorized technical service.

Safety



It is imperative to follow safety guidelines to prevent electric shock, injury, fire or explosion.

- Do not use the units for any purpose other than soldering or rework. Incorrect use may cause fire.
- The power cord must be plugged into approved bases. Be sure that it is properly grounded before use. When unplugging it, hold the plug, not the wire.
- Do not work on electrically live parts.
- The tool should be placed in the stand when not in use in order to activate the sleep mode. The soldering tip, the metal part of the tool and the stand may still be hot even when the station is turned off. Handle with care, including when adjusting the stand position.
- Do not leave the appliance unattended when it is on.
- Do not cover the ventilation grills. Heat can cause inflammable products to ignite.
- Avoid the contact of flux with skin or eyes to prevent irritation.
- Be careful with the fumes produced when soldering.
- Keep your workplace clean and tidy. Wear appropriate protection glasses and gloves when working off to avoid personal harm.
- Utmost care must be taken with liquid tin waste which can cause burns.
- This appliance can be used by children over the age of eight and also persons with reduced physical, sensory or mental capabilities or lack of experience provided that they have been given adequate supervision or instruction concerning use of the appliance and understand the hazards involved. Children must not play with the appliance.
- Maintenance must not be carried out by children unless supervised.

Exploded View

PSE-1A 120V
PSE-2A 230V
PSE-9A 100V

FOUR-TOOL POWER SUPPLY UNIT

PSE-1A / PSE-2A / PSE-9A

SPARE PARTS	
PSE-1A / PSE-2A / PSE-9A:	
-CIRCUIT	0013607
-ENCLOSURE	
· TOP	0011035
· BOTTOM	0014567
· FRONT	0012691
· BACK	0011861

PSE-1A 120V FUSE T-6A
PSE-2A 230V FUSE T-15A
PSE-9A 100V FUSE T-8A

0012724
 BATTERY
 CR2032

0013607

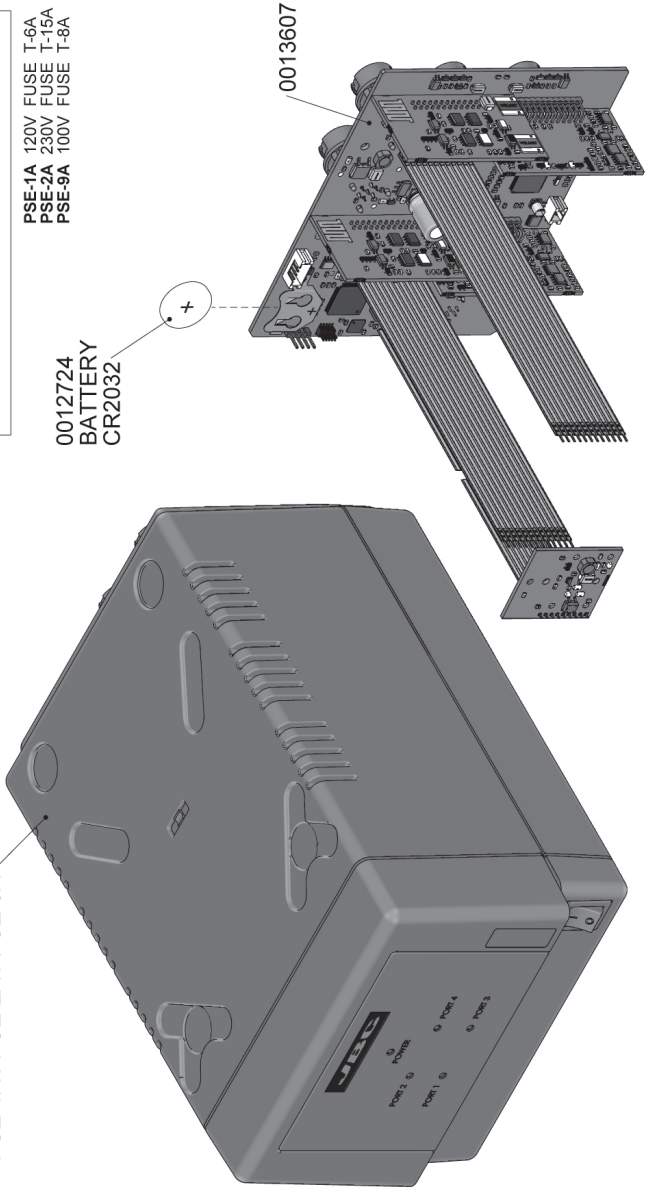

Specifications

PSE-1A 120V 50/60Hz. Input fuse: 6A. Output: 23.5V

PSE-2A 230V 50/60Hz. Input fuse: 3.15A. Output: 23.5V

PSE-9A 100V 50/60Hz. Input fuse: 8A. Output: 23.5V

- Weight: 4.258 Kg (9.38 lb)
- Dimensions: 148 x 120 x 232 mm
- Output Peak Power: 160W per tool
- Temperature Range: 90 - 450 °C / 190 - 840 °F (±5%)
- Idle Temp. Stability (still air): ±1.5 °C / ±3 °F
- Tip to ground resistance: <2 ohms
- Tip to ground voltage: <2mV RMS
- Ambient operating temp: 10 - 40 °C / 50 - 104 °F
- Connections: USB-B / Peripherals connectors
RJ12 connector for Robot & DME
RJ12 connector for PSE
RJ45 connector for LAN (Ethernet)

Complies with CE standards

ESD protected housing "skin effect"

JBC

Warranty

JBC's 2 year warranty covers this equipment against all manufacturing defects, including the replacement of defective parts and labour.

Warranty does not cover product wear or its misuse.

In order for the warranty to be valid, equipment must be returned, postage paid, to the dealer where it was purchased.



This product should not be thrown in the garbage.

In accordance with the European directive 2002/96/EC, electronic equipment at the end of their life must be collected and returned to an authorized recycling facility.

Manual in other languages available on our website

www.jbctools.com

0013606-0916