

JBC

www.jbctools.com



Guide Kit for SFR

Ref. GSFR

Packing List

Guide Kit with Solder Wire Perforation

The following items should be included:

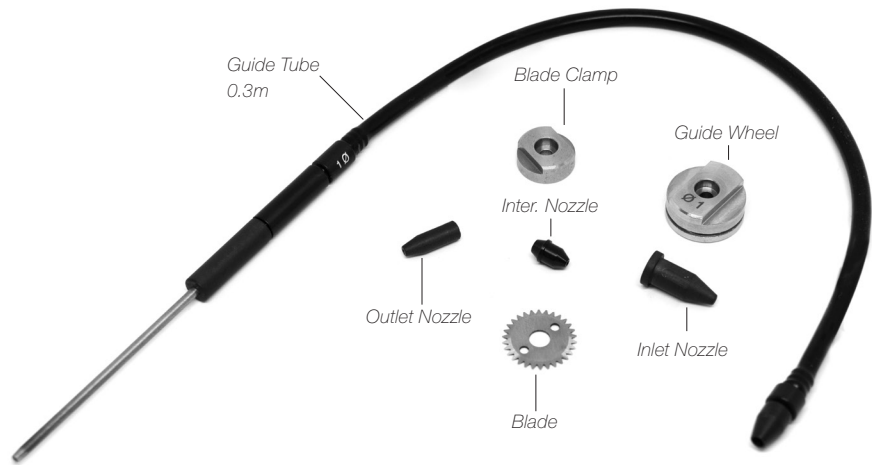

Ref.	Solder Wire Ø (mm)	Guide Wheel Ref.	Blade Clamp Ref.	Blade Ref.	Inlet Nozzle Ref.	Outlet Nozzle Ref.	Inter. Nozzle Ref.	Guide Tube Ref.
GSFR08V03	0.8	0021275	0017999	0020716	0020962	0021027	0020963	0021617
GSFR10V03	1.0	0018871				0020950		0021537
GSFR15V03	1.5	0021700			0020950	0021301	0021302	0021685

One unit included from each component.

Manual 1 unit
Ref. 0021649



Guide Kit without Solder Wire Perforation

The following items should be included:

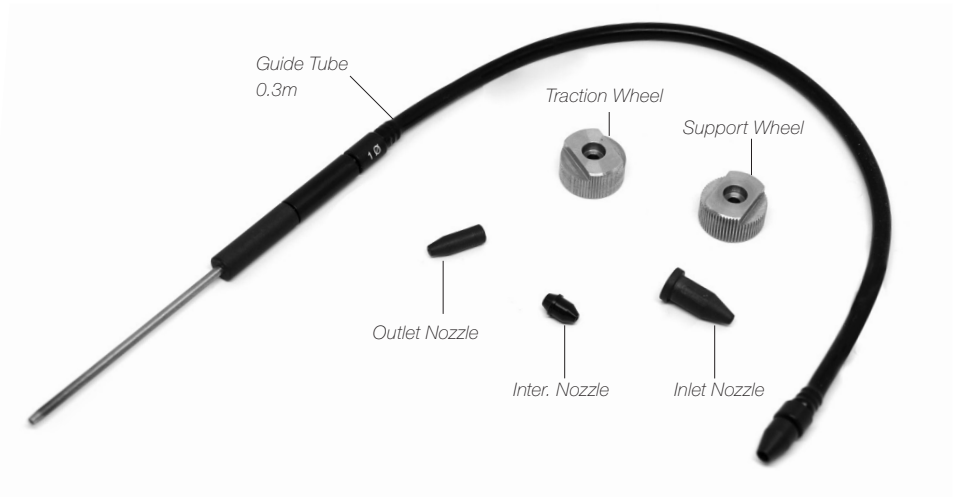

Ref.	Solder Wire Ø (mm)	Traction Wheel Ref.	Support Wheel Ref.	Inlet Nozzle Ref.	Outlet Nozzle Ref.	Inter. Nozzle Ref.	Guide Tube Ref.
GSFR05D03	0.5	0018335	0019510	0020962	0021027	0020963	0021687
GSFR08D03	0.8		0018845				0021301
GSFR10D03	1.0			0018353	0021302	0021537	
GSFR15D03	1.5						

One unit included from each component.

Manual 1 unit
Ref. 0021649

Features

The GSFR (Guide Tube Kit) is designed to be used with the Automatic Solder Feeder for Automation (SFR) in automatic soldering processes.



Assembly: GSFR Wheels to SFR*

For this operation, disconnect the device, and dismantle the Cover by pushing the tabs. Use the allen key and the spanner, provided with the SFR, to assemble the following components.

1. Insert the Intermediate Nozzle until its collar rests against the housing and tighten the screw
2. Assemble the Guide Wheel and tighten the screw. If you use a Guide Kit without Solder Wire Perforation assemble the Support Wheel.
3. If you have a Guide Kit with Solder Wire Perforation assemble the Blade first, then mount the Blade Clamp onto the same axis and tighten the screw. If you use a Guide Kit without Solder Wire Perforation, assemble the Traction Wheel.

Caution: handle the blade carefully to avoid injury.

4. Insert the Inlet Nozzle into the hole and tighten the screw.

GSFR with Solder Wire Perforation

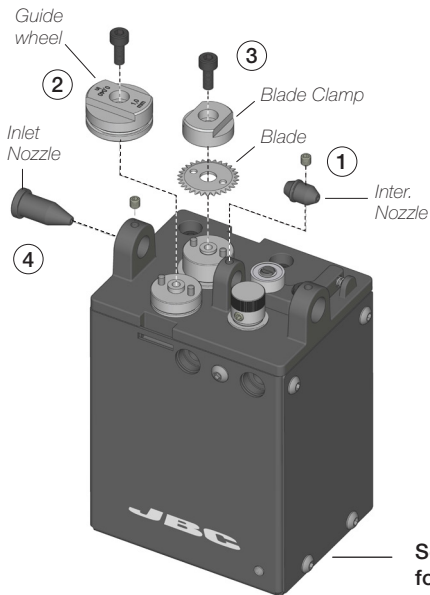

GSFR without Solder Wire Perforation

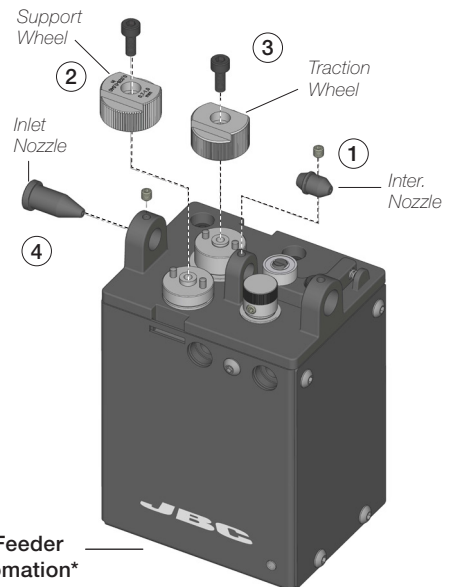

Solder Feeder
for Automation*
Ref. SFR-A

**Not included, sold separately*

Assembly: GSFR Tube to SFR* and RBA*

1. Assemble the SFR to the RBA with the screws.
2. Assemble the GSFR Guide Tube to the RBA and tighten the screw.
3. Assemble the Outlet Nozzle onto the Dispensing Tube.
4. Assemble the GSFR Bushing into the SFR hole and tighten the screw.
5. Finally attach the Reel Support to the SFR with its screws.

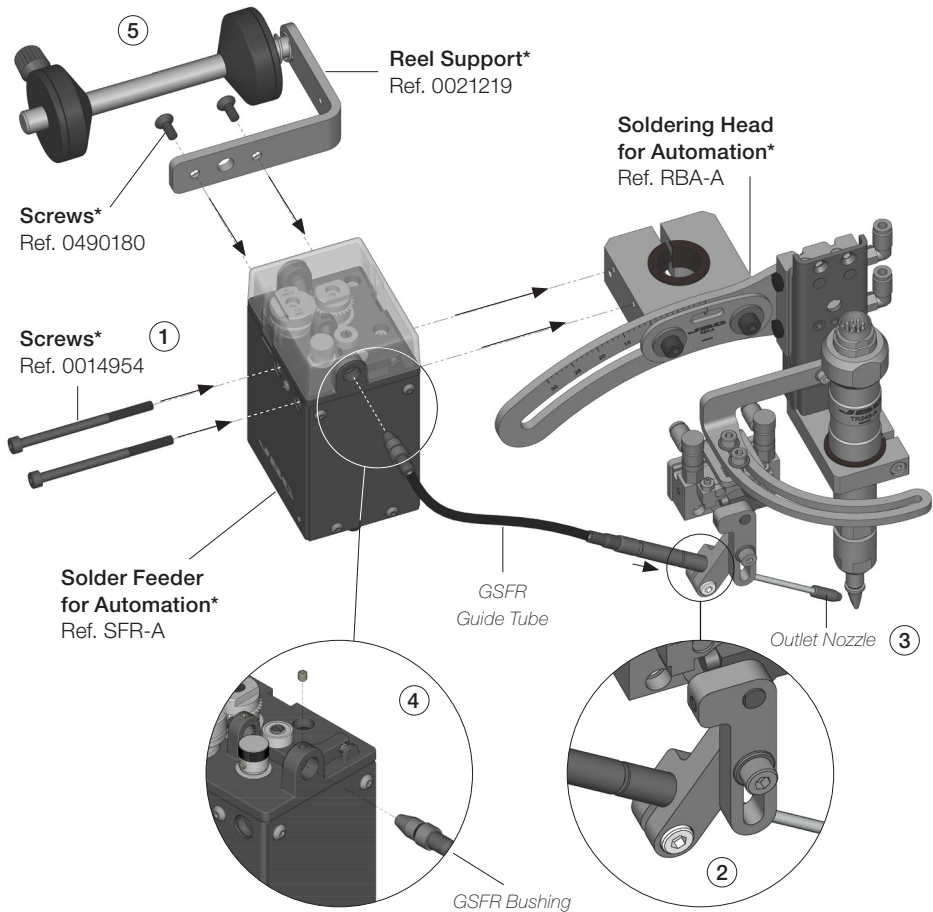

**Not included, sold separately*

Load the Solder Wire

The GSFR must be assembled previously.

1. Feed the Solder Wire into the Inlet Nozzle until it reaches the wheels.
2. Make sure the wire passes through the Intermediate Nozzle and enters into the Guide Tube.

Wire feeding is controlled by an external controller (Robot/PLC/Computer). See the Robot Communication Protocol for the SFR unit at www.jbctools.com/jbcsoftware.html

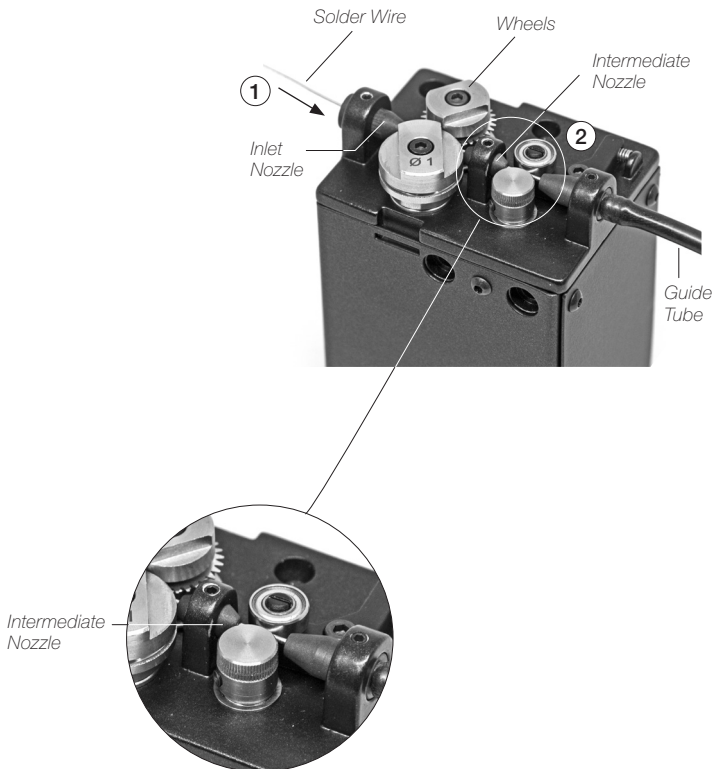

Maintenance

- Before carrying out maintenance, always unplug the tool and the device.
- Use a damp cloth to clean the tool. Alcohol can only be used to clean the metal parts.
- Periodically check that the metal parts of the mechanism are clean.
- Keep Dispensing Nozzle Tip clean to avoid solder feeding obstruction.
- Periodically check all cables and tube connections.
- Replace any defective or damaged parts. Use original JBC spare parts only.
- Repairs should only be performed by a JBC authorized technical service.

Safety







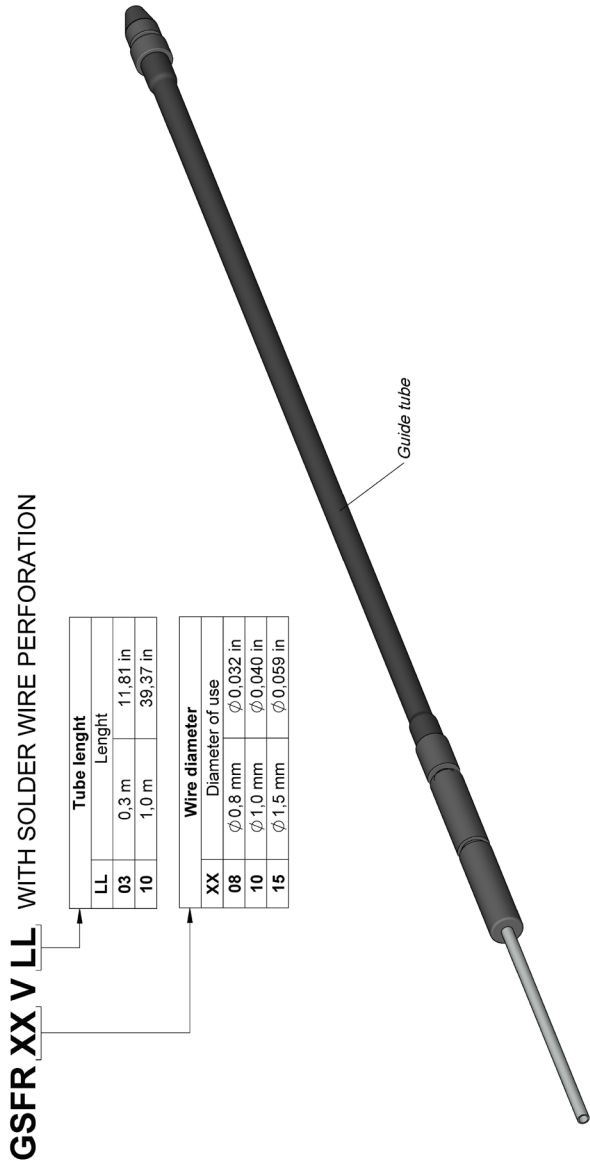

It is imperative to follow safety guidelines to prevent electric shock, injury, fire or explosion.

- Do not use the device for any other purpose.
- Be sure that the power supply is disconnected before changing any spare part.
- Avoid flux coming into contact with skin or eyes to prevent irritation.
- Be careful of fumes produced while soldering.
- Keep your workplace clean and tidy. Wear appropriate protective glasses and gloves while handling components to avoid personal injury.
- Utmost care must be taken with liquid tin waste which can cause burns.

Exploded View







	Outlet nozzle	Guide wheel	Blade	Blade clamp	Inlet nozzle	Intern. nozzle
						
GSFR08VLL	0021560	0018637	0021555	0018638	0020962	0020963
GSFR10VLL	0021559	0019172			0021301	0021302
GSFR15VLL		0019696				

GSFR XX D LL WITHOUT SOLDER WIRE PERFORATION

Tube lenght	
LL	Lenght
03	0,3 m 11,81 in
10	1,0 m 39,37 in

Wire diameter	
XX	Range of use
05	Ø 0,5 - 0,6 mm Ø 0,020 - 0,025 in
08	Ø 0,7 - 0,8 mm Ø 0,028 - 0,032 in
10	Ø 0,9 - 1,0 mm Ø 0,035 - 0,040 in
15	Ø 1,2 - 1,5 mm Ø 0,047 - 0,059 in

Guide tube

	Outlet nozzle	Traction wheel	Support wheel	Inlet nozzle	Intern. nozzle
GSFR05DLL GSFR08DLL GSFR10DLL GSFR15DLL					
	0021560	0019479	0019519	0020962	0020963
	0021559		0019480		
			0019481		

Notes

This image shows a single sheet of white paper with horizontal ruling lines. The lines are evenly spaced and run across the width of the page. There are no margins, text, or other markings on the paper.

This image shows a single sheet of white paper with horizontal ruling lines. The lines are evenly spaced and run across the width of the page. There are no margins, text, or other markings on the paper.

Specifications

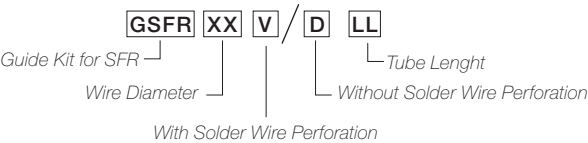

Solder Wire Ø (mm)	With Solder Wire Perforation	Solder Wire Ø (mm)	Without Solder Wire Perforation
-	-	0.5-0.6	GSFR05D03
0.8	GSFR08V03	0.7-0.8	GSFR08D03
1.0	GSFR10V03	0.9-1.0	GSFR10D03
1.5	GSFR15V03	1.2-1.5	GSFR15D03

- Net Weight:

42 g (0.09 lb)

- Tube Lenght:

30 cm

Complies with CE standards.

ESD protected.



Warranty

JBC's two-year warranty covers this equipment against all manufacturing defects, including the replacement of defective parts and labour. Warranty does not cover product wear or misuse. In case of any manufacturing defect, the equipment must be returned, postage paid, to the dealer where it was purchased.



This product should not be thrown in the garbage. In accordance with the European directive 2002/96/EC, electronic equipment at the end of their life must be collected and returned to an authorized recycling facility.



Manual in other languages available on our website

www.jbctools.com